

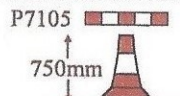







<b>KEY</b> 01A ADVANCED WARNING ACCESS TO ROAD AHEAD CLOSED ON → TO ← FOR → DAY/S FROM → TO ←	 <b>ROAD CLOSED</b>	<b>ROAD AHEAD CLOSED FOLLOW DIVERSION</b> 02	<b>Diverted traffic</b> → 04	<b>Diverted traffic</b> ↑ 06	<b>Diversion</b> ← 08	<b>ROAD AHEAD CLOSED</b> 10	<b>Diverted traffic</b> ↻ 12	 Diverted traffic	 15
		<b>Diversion ENDS</b> 03	<b>Diverted traffic</b> ← 05	<b>Diversion</b> → 07	<b>Diversion</b> ↑ 09	<b>Diverted traffic</b> ↻ 11	<b>Diverted traffic</b> ↻ 13		

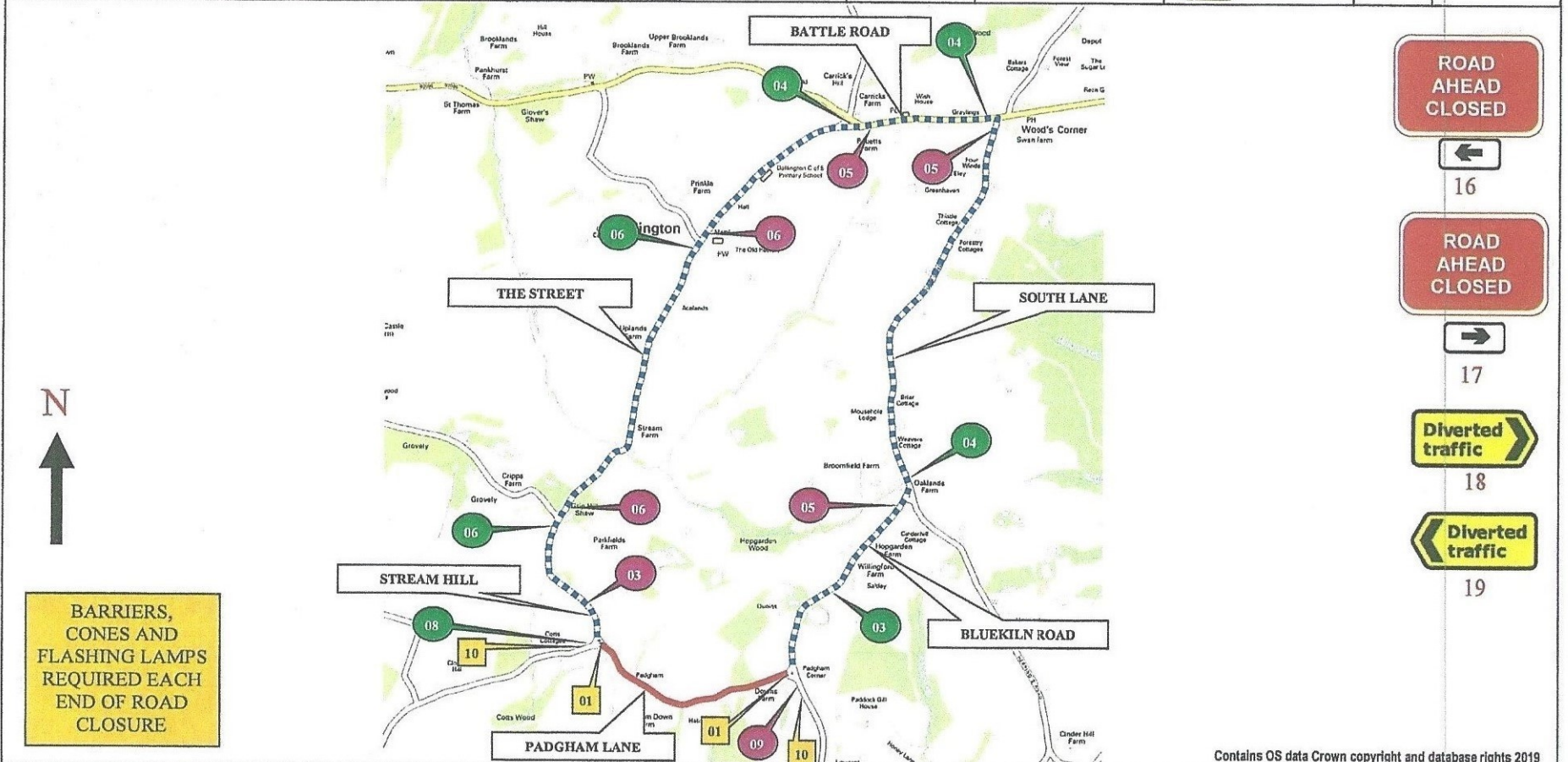

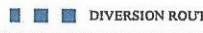
Contains OS data Crown copyright and database rights 2019

 <b>ALUX PLANT</b> TRAFFIC CONTROL & MANAGEMENT  A-Plant Lux Traffic Control & Management Kemble Airfield Enterprise Park Cirencester Road Kemble GL7 6BQ	<b>NOTES</b> 1. ALL EQUIPMENT SHALL BE APPROVED AND SHALL COMPLY WITH THE DEPARTMENT OF TRANSPORT SPECIFICATION MCE0111. THIS DRAWING DOES NOT SHOW THE NORMAL ROADWORKS SIGNING THAT WILL BE REQUIRED (category 4). 2. ALL SIGNS TO BE IN ACCORDANCE WITH TSGRD 2002 AND TO MINIMUM CLASS 2 RETROREFLECTIVE. 3. MINIMUM HEIGHT OF LETTERING TO BE 60MM AND SIGN BOARDS TO BE MIN 1000MM x 750MM (4) WHERE APPROPRIATE.  THIS DRAWING IS PROTECTED BY COPYRIGHT AND THE INFORMATION CONTAINED THEREIN IS CONFIDENTIAL. THE DRAWING MAY NOT BE COPIED AND THE INFORMATION CONTAINED THEREIN MAY NOT BE USED, OR DISCLOSED TO A THIRD PARTY, WHOLLY OR IN PART WITH THE WRITTEN PERMISSION OF APLANT LUX TRAFFIC CONTROLS LTD.	CROWN COPYRIGHT DATA REPRODUCED BY PERMISSION OF THE CONTROLLER OF HMSO					<b>KEY</b>  ROAD CLOSURE  DIVERSION ROUTE   ANTI-CLOCKWISE DIVERSION  CLOCKWISE DIVERSION  ROAD CLOSURE SIGN		
		<b>CLIENT DETAILS</b> OPENREACH	<b>REP/DEPOT</b> RR/131	<b>DRAWN BY</b> RC	<b>ADDRESS</b> PADGHAM LANE DALLINGTON EAST SUSSEX TN21 9NS			<b>ROAD CLOSURE LENGTH APPROX</b> ROAD CLOSURE WIDTH APPROX	620M 3.5M
		<b>AMEND NO</b> 00	<b>SHEET NO.</b> 1 OF 1	<b>DATE</b> 24/06/2019	<b>SUITABLE TIME TO UNDERTAKE THE WORKS</b>				
		<b>OFFPEAK</b> X	<b>NIGHT</b> 2100-0600	<b>WEEKEND</b>	<b>WEEKDAY</b> 0800-1700	<b>24 HOUR WORKS</b>		<b>HIRE ADVICE</b>	131-S003526

BUS ROUTE AFFECTED